

Revision No. 4	Page 1 of 3	<div>Technical Definition</div> <div>Flat dadN – Aluminium 2024</div>
<div>ptp.</div>		
<div>Kit 4-3-2020 PTP Metallic</div>		

You shall respect the HSE policy of your laboratory for each performed test.

Instructions to participant laboratories

Please read these instructions carefully BEFORE starting the tests.

1. Five blanks (304 x 105 x 3 mm) are supplied to each participant – 5 results must be provided. If one result is missing, your test will be considered as an outlier. A RCA shall be completed.
2. The test specimen shall be machined in accordance with the requirements of **ASTM E647-15e1** – Middle Tension Geometry CCTW100 (see below).

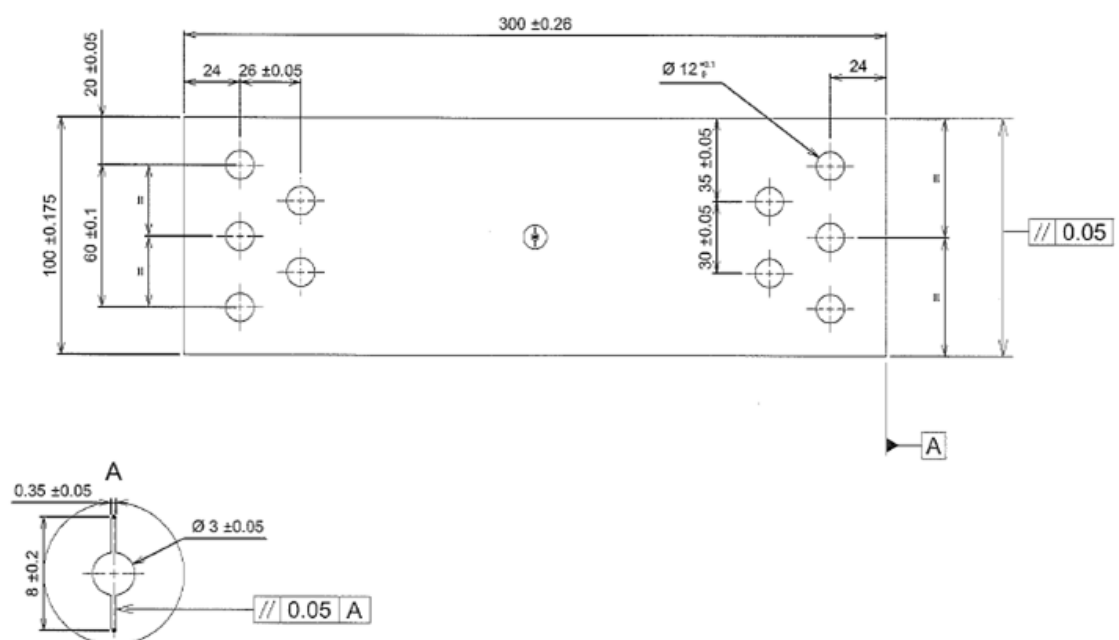

Figure 1 : Geometry CCTW100

3. All tests are to be performed in accordance with the requirements of **ASTM E647-15e1** at ambient conditions.

Temperature	Room temperature
Ratio	0,1
Frequency	10 – 20 Hz
Yield Strength	320 MPa
Young's modulus	73 GPa

The parameters of the $da/dN=f(\Delta K)$ curve (in **mm/cycle**) shall be determined between $\Delta K=11 \text{ MPa}\sqrt{\text{m}}$ and $\Delta K= 20 \text{ MPa}\sqrt{\text{m}}$.

Revision No. 4	Page 2 of 3	<div>Technical Definition</div> <div>Flat dadN – Aluminium 2024</div>
<div>ptp.</div>		
<div>Kit 4-3-2020 PTP Metallic</div>		

The tests shall be performed respecting the following conditions:

- One operator only
- One testing machine only
- Tests performed in sequence

4. The following characteristics are to be reported:

Characteristic	Unit	Significant digits	Mandatory / Not mandatory	Evaluated Yes/no
Specimen dimensions	mm	X,XX	Mandatory	No
Test method	N/A	N/A	Mandatory	No
C (coefficient of Paris' law)	N/A	X,XXX.10 ^{-x}	Mandatory	Yes
m (coefficient of Paris' law)	N/A	X,XXX	Mandatory	Yes
Raw data as indicated in the ASTM	N/A	N/A	Mandatory	No
Graphical representation	N/A	N/A	Mandatory	No

All evaluated characteristics will be analysed according to the algorithm A (ISO 13528 – 2015) and evaluated using z-score. The algorithm will be applied to the logarithm of the results.

5. Testing shall start **as soon as test specimens are received**. Please contact the following e-mail address for any technical or administrative query.

Submission date :	July 1st, 2020
Technical and administrative support :	info@ptpscheme.com

6. Instructions for submission of results are detailed on the website:

<https://ptpscheme.com>

7. To ensure the confidential treatment of your results in the final report, you will be allocated a unique identity number when you register for the program.

8. Collusion and falsification of your PTP results are totally forbidden. In case of identification or suspicion of collusion or falsification, the laboratory will be excluded from the program and the sponsors will be immediately informed. The sponsors could ask you proofs of your records and analyses, so be sure to conserve data, curves and specimens.

9. The tested specimens do not need to be sent back to PTP.

Revision No. 4	Page 3 of 3	<div>Technical Definition</div> <div>Flat dadN – Aluminium 2024</div>
<div>ptp.</div>		
<div>Kit 4-3-2020 PTP Metallic</div>		

APPENDIX: Instructions for IRR participation

The Internal Round Robin participation (IRR) is **optional** and **independent** from your PTP participation.

Confidentiality: The IRR results and reports are confidential and only accessible by your laboratory. They are not shared with the scheme sponsors or any other accreditation or certification bodies.

The extra samples shall be tested according to the following table:

	Operator 1	Operator 2	Operator 3	Operator 4	Operator X
Test machine 1	PTP kit (5 samples)	1 sample	1 sample	1 sample	1 sample
Test machine 2	1 sample				
Test machine 3	1 sample				
Test machine Y	1 sample				

Operator 1 (OP1) is to be the most experienced operator currently conducting tests on a regular basis and shall perform tests on all machines (TM1, TM2, TM3...)

Test Machine 1 (TM 1) is to be the most utilised machine for this test in your laboratory and shall be tested by all operators (OP1, OP2, OP3...)

Example: A laboratory has 2 operators and 3 test machines. They receive a PTP kit and 3 extra specimens.

Operator 1 shall test the PTP kit on TM1, 1 specimen on TM2 and 1 specimen on TM3.

Operator 2 shall test 1 specimen on TM1.

The IRR results have to be submitted on a separate results form available on the PTP website.

The identification of operators and test machines you provide will appear on the IRR final report. These identifications will not be seen by other laboratories.

The IRR results will be classified against the acceptance classes of the kit 4-3-2020.

Reminder: Laboratories are not permitted to switch specimens between the PTP kit and IRR samples. The traceability of the samples will be checked during the evaluation. Laboratories found to have switched samples will invalidate their PTP participation.

REVISION HISTORY

Issue Date	Issue N°	Changes
06/01/2020	1	Document creation
09/03/2020	2	Add of technical parameters Modification of the results submission date
27/05/2020	3	Modification of the results submission date
26/06/2020	4	Clarification of unit for da/dN results